

**SCHWARTZ
CENTER
RENOVATION
& ADDITION**

**CAPE FEAR
COMMUNITY
COLLEGE**

**CONSTRUCTION
DOCUMENTS
BID SET**

DEPT. OF COMMUNITY COLLEGES
SCHWARTZ CENTER
RENOVATION & ADDITION
STATE ID # 16-14200-01A
NCCCS # 2102

LSP

LSP ASSOCIATES LTD.
101 NORTH THIRD STREET SUITE 500
WILMINGTON, NORTH CAROLINA 28401
TEL. 910.790.5111
WWW.LSP.COM

NORRIS & TUNSTALL
CONSULTING ENGINEERS P.C.
1400 HARRIS BLVD. SUITE 200
FARMERSVILLE, NC 28534
919.753.1100

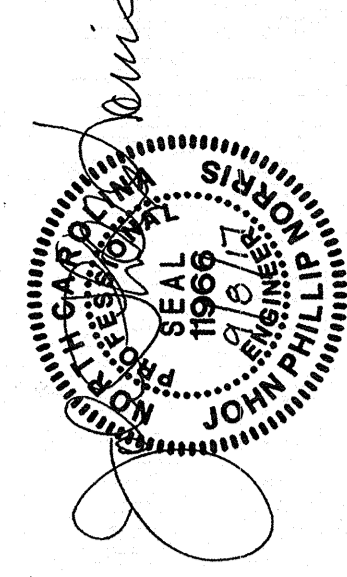

MEMBERS OF THE AMERICAN INSTITUTE OF ARCHITECTS
COPYRIGHT 2017. ALL RIGHTS RESERVED.
NO PART OF THIS DOCUMENTATION MAY BE REPRODUCED
IN ANY FORM WITHOUT WRITTEN
PERMISSION FROM LSP ASSOCIATES LTD.

REVISIONS

PROJECT: 7202-15550
DATE: 09/05/2017
DRAWN BY: EDB
CHECKED BY: JPN

**EXISTING
CONDITIONS
/ SITE
INVENTORY**

C-100

SOLUTIONS THROUGH LISTENING

SITE INVENTORY DATA

PLAN PREPARED:	LSP & NORRIS & TUNSTALL CONSULTING ENGINEERS
APPLICANT NAME:	J. PHILIP NORRIS, P.E.
SITE ADDRESS:	610 NORTH FRONT STREET
PROJECT OWNER:	CAPE FEAR COMMUNITY COLLEGE
PROJECT NUMBER:	7202-15550
PARCEL #:	804716-007-001-000
ZONING:	CSB
ADJACENT PROPERTY OWNER:	CAPE FEAR COMMUNITY COLLEGE - CSB
VEHICLE MAKE:	SEE PLAN
TOPOGRAPHIC DATA:	SEE PLAN
100 YR FLOOD ELEVATION:	N/A
LOCATION OF WALK FEATURES:	N/A
DATA DATE:	N/A
DATA CLASSIFICATION:	URBAN
CONSERVATION RESOURCES:	N/A
RECORDED SITE:	NO RECOGNITION
CEMETERIES:	N/A
FORESTED AREAS:	N/A
WETLANDS:	N/A
PREFABRICATED SPEEDS:	N/A
TRANSFORMATION DATA:	SEE PLAN

LEGEND

---	RIGHT OF WAY
---	EXISTING CONTOUR
---	EXISTING STORM DRAIN
---	EXISTING SANITARY SEWER
○	EXISTING TREE

SCALE: 1" = 20'

CITY OF WILMINGTON
NORTH CAROLINA
Public Services • Engineering Division
APPROVED DRAINAGE PLAN
Date: 10/2/2017 Permit # 2017041
Signed: *Michelle D. Smith*

Approved Council Plan
Plan: 104117
Title: *N. Front St*
Date: *10/2/17*
By: *C. Williams*

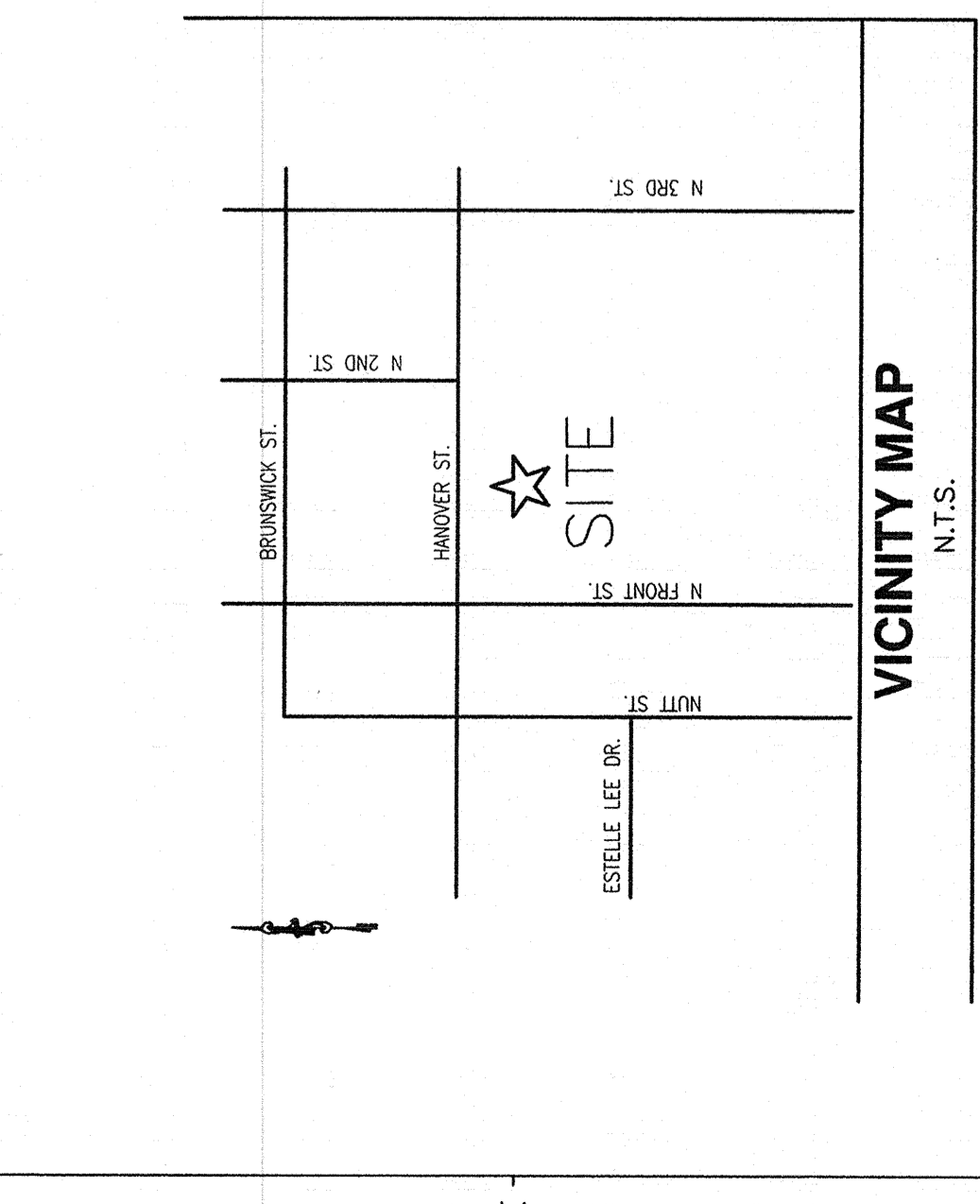
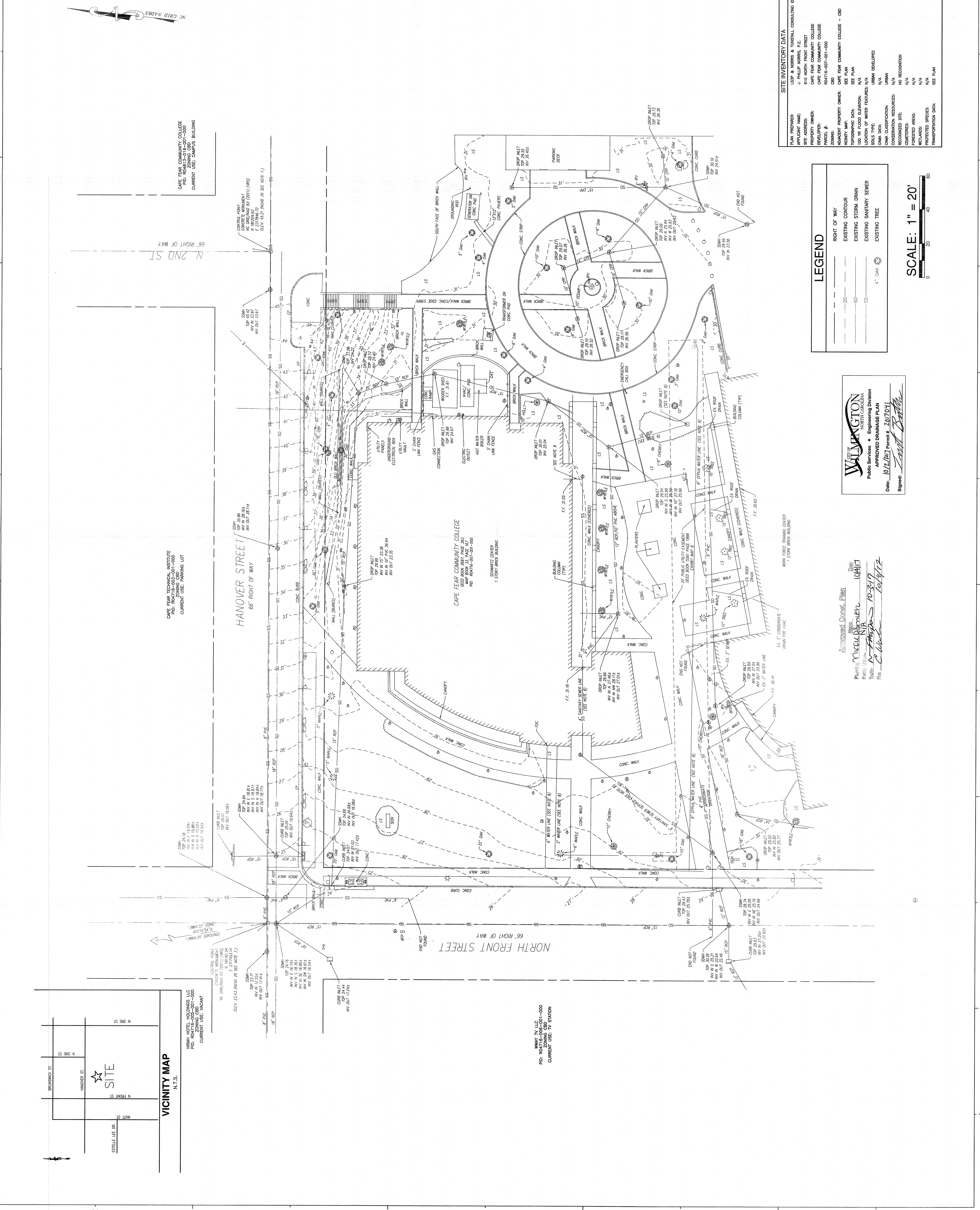

6
5
4
3
2
1

E
D
C
B
A

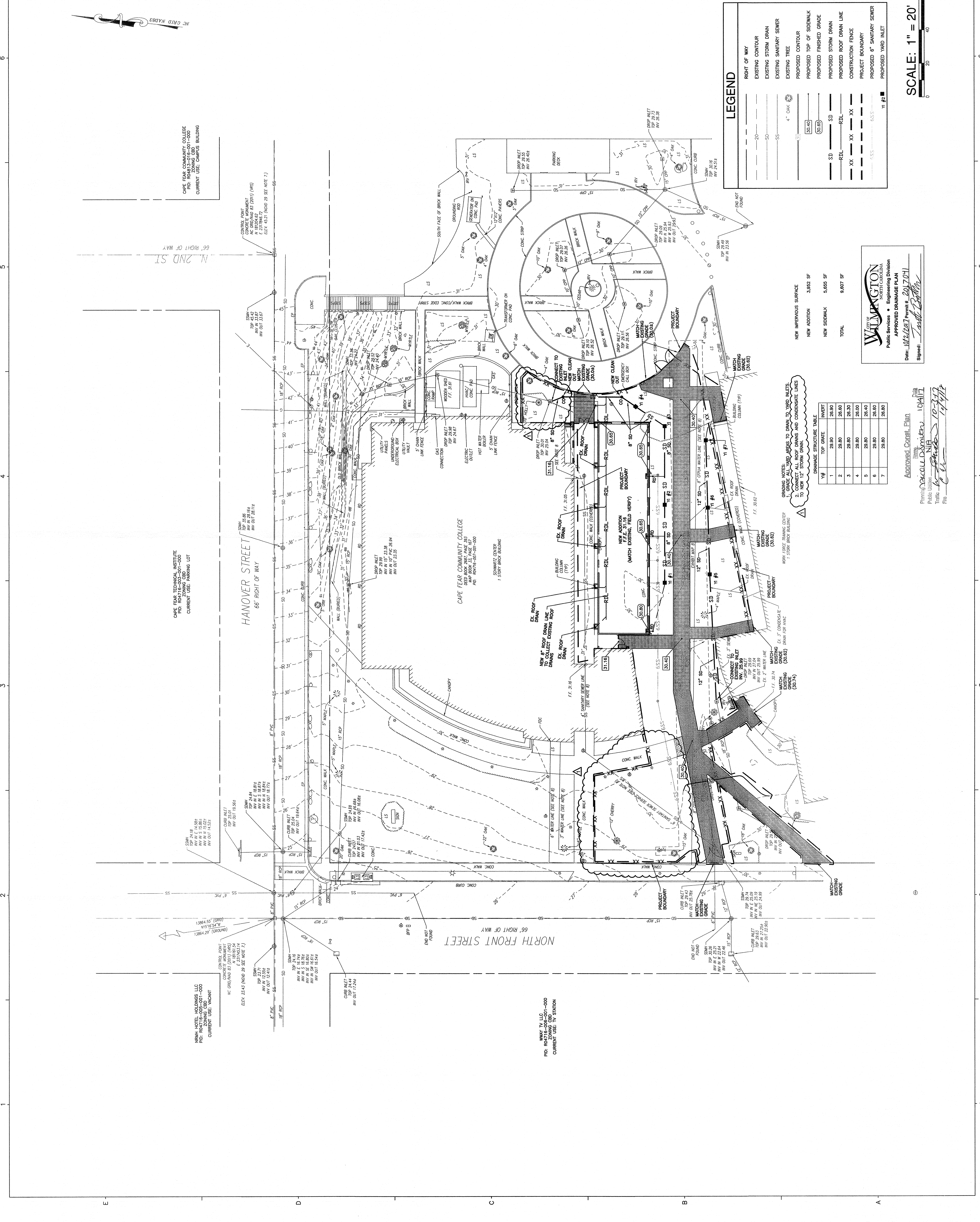
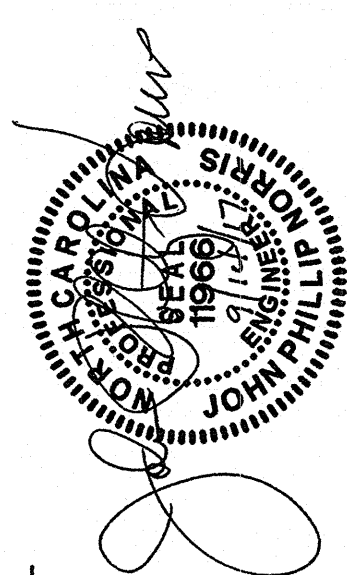

LEGEND

RIGHT OF WAY	
---	EXISTING CONTOUR
---	EXISTING STORM DRAIN
---	EXISTING SANITARY SEWER
---	EXISTING TREE
---	PROPOSED CONTOUR
---	PROPOSED TOP OF SIDEWALK
---	PROPOSED FINISHED GRADE
---	PROPOSED STORM DRAIN
---	PROPOSED ROOF DRAIN LINE
---	CONSTRUCTION FENCE
---	PROJECT BOUNDARY
---	PROPOSED 6" SANITARY SEWER
---	PROPOSED 18" SANITARY SEWER

NEW IMPERVIOUS SURFACE	3,882 SF
NEW ADDITION	5,655 SF
NEW SIDEWALK	9,407 SF
TOTAL	18,944 SF

WILMINGTON
NORTH CAROLINA
Public Services • Engineering Division
APPROVED DRAINAGE PLAN
Date: 10/2/2017 Permit # 2017-011
Signed: *Scott Butler*

DRAINAGE STRUCTURE TABLE

NO.	TYPE	TOP RATE	INVERT
1	1	28.90	28.90
2	2	29.80	28.60
3	3	29.80	28.30
4	4	29.80	28.00
5	5	29.80	26.40
6	6	29.80	26.60
7	7	29.80	26.80

GRADING NOTES:
1. GRADE ALL YARD AREAS TO DRAIN TO YARD INLETS.
2. CONNECT ALL ROOF DRAINS AND CONDUIT LINES TO NEW 12" STORM DRAIN.

SCALE: 1" = 20'
0 20 40 60

Approved Contract Plan
Planning: *Carol K. Miller*
Public Use: *John A. Miller*
Title: *10-237*
Date: *10/2/17*
Fig. *10-237*

6

5

4

3

2

1

6

5

4

3

2

1

E D C B A

**SCHWARTZ
CENTER
RENOVATION
& ADDITION**

**CAPE FEAR
COMMUNITY
COLLEGE**

**CONSTRUCTION
DOCUMENTS
BID SET**

DEPT. OF COMMUNITY COLLEGES
SCHWARTZ CENTER
RENOVATION & ADDITION
STATE ID # 16-14200-01A
NCCCS # 2102

LSP

LSP ASSOCIATES LTD.
101 NORTH THIRD STREET SUITE 300
WILMINGTON, NORTH CAROLINA 28401
TEL. 910.790.9691 FAX 910.790.3111
WWW.LSP.COM

NORRIS & TUNSTALL
ARCHITECTS
1000 MARKET STREET SUITE 200
WILMINGTON, NORTH CAROLINA 28401
TEL. 910.790.9691 FAX 910.790.3111
WWW.NORRISANDTUNSTALL.COM

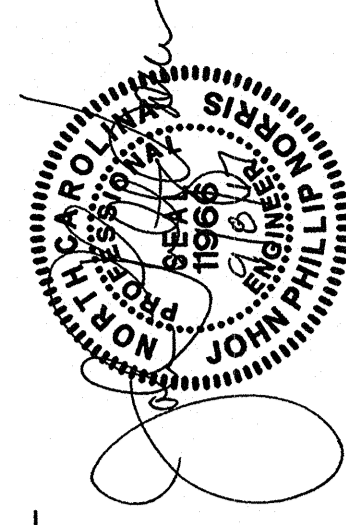

MEMBERS OF THE AMERICAN INSTITUTE OF ARCHITECTS
COPYRIGHT 2017. ALL RIGHTS RESERVED.
THIS DOCUMENT IS THE PROPERTY OF NORRIS & TUNSTALL ARCHITECTS.
IT IS TO BE USED ONLY FOR THE PROJECT AND SITE SPECIFICALLY IDENTIFIED
HEREIN. NO PART OF THIS DOCUMENT MAY BE REPRODUCED
OR TRANSMITTED IN ANY FORM WITHOUT WRITTEN
PERMISSION FROM LSP ASSOCIATES LTD.

REVISIONS:

PROJECT: 7202-15060
DATE: 09/09/2017
DRAWN BY: EDB
CHECKED BY: JPN

UTILITY
PLAN

C-104

SOLUTIONS THROUGH LISTENING

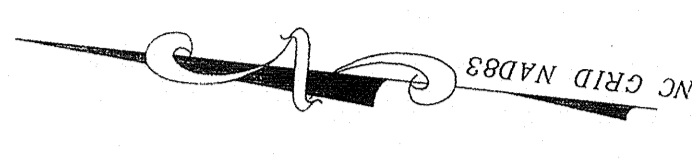

CAPE FEAR COMMUNITY COLLEGE
PID: R04313-00-001-000
CURRENT USE: CAMPUS BUILDING

N 2ND ST
66' RIGHT OF WAY

CAPE FEAR TECHNICAL INSTITUTE
PID: R04313-00-001-000
CURRENT USE: PARKING LOT

HANOVER STREET
66' RIGHT OF WAY

CAPE FEAR COMMUNITY COLLEGE
DEPT. OF COMMUNITY COLLEGES
PID: R04313-00-001-000
CURRENT USE: TV STATION

WAY TV LLC
PID: R04313-00-001-000
CURRENT USE: TV STATION

LEGEND

---	RIGHT OF WAY
---	EXISTING CONTOUR
---	EXISTING STORM DRAIN
---	EXISTING SANITARY SEWER
---	EXISTING TREE
---	PROPOSED CONTOUR
---	PROPOSED TOP OF SIDEWALK
---	PROPOSED FINISHED GRADE
---	PROPOSED STORM DRAIN
---	PROPOSED ROOF DRAIN LINE
---	CONSTRUCTION FENCE
---	PROPOSED 6" SANITARY SEWER

SCALE: 1" = 20'
0 20 40 60

WILMINGTON
Public Services • Engineering Division
APPROVED DRAINAGE PLAN
Date: 10/12/2017 Permit # 20170411
Signed: *Jeff Ball*

Approved Consultant
Name: *Jeff Ball*
Title: *PE*
Date: *10/12/17*
File: *10-3-17*
10/14/17

CONTRACTOR TO FIELD VERIFY INVERT OF EXISTING 6" SANITARY LINE BEFORE INSTALLING NEW 6" SANITARY SEWER LINE. CONFIRM THAT BUILDING ADDITIONS AT A 0.5% MINIMUM SLOPE.

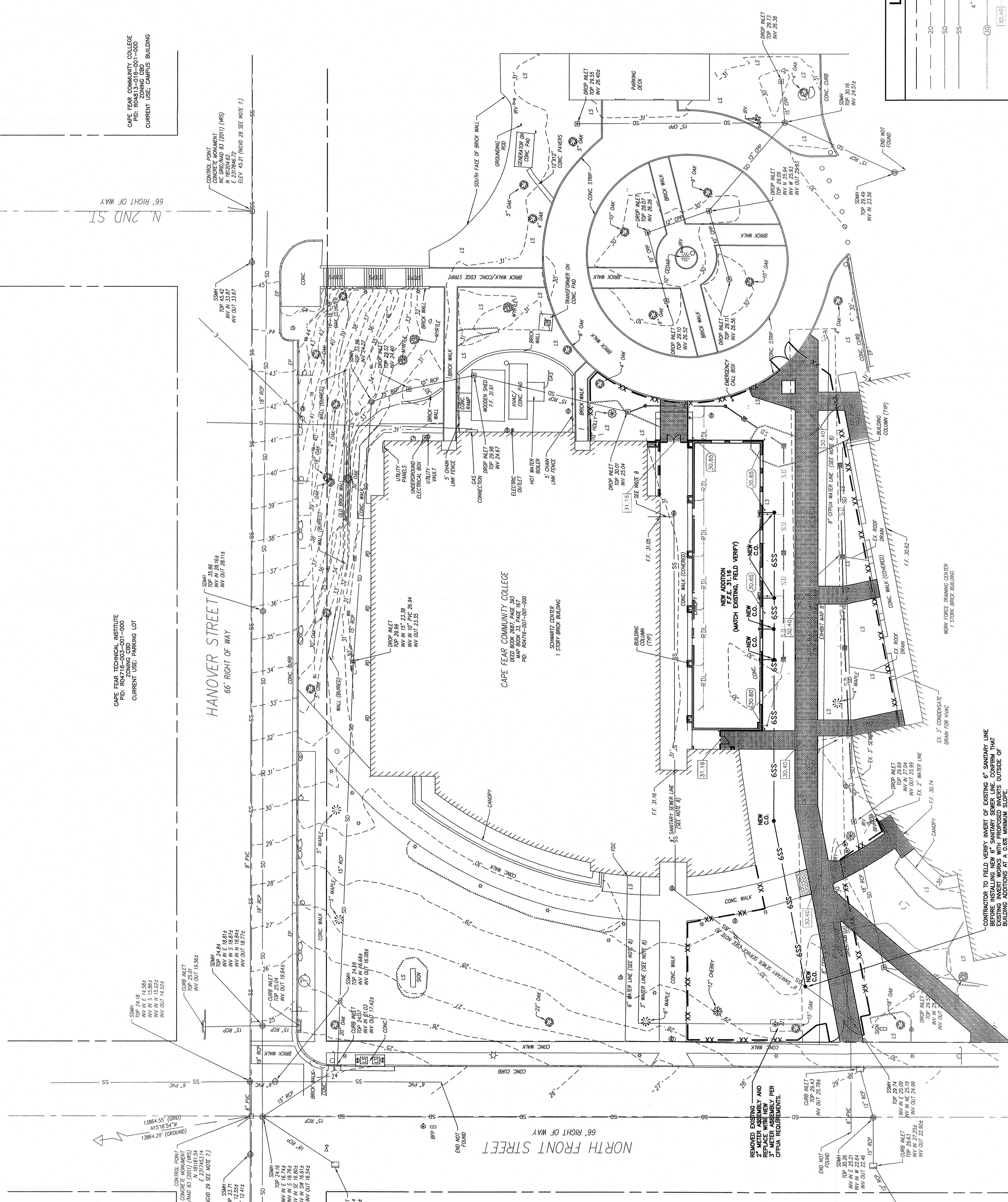

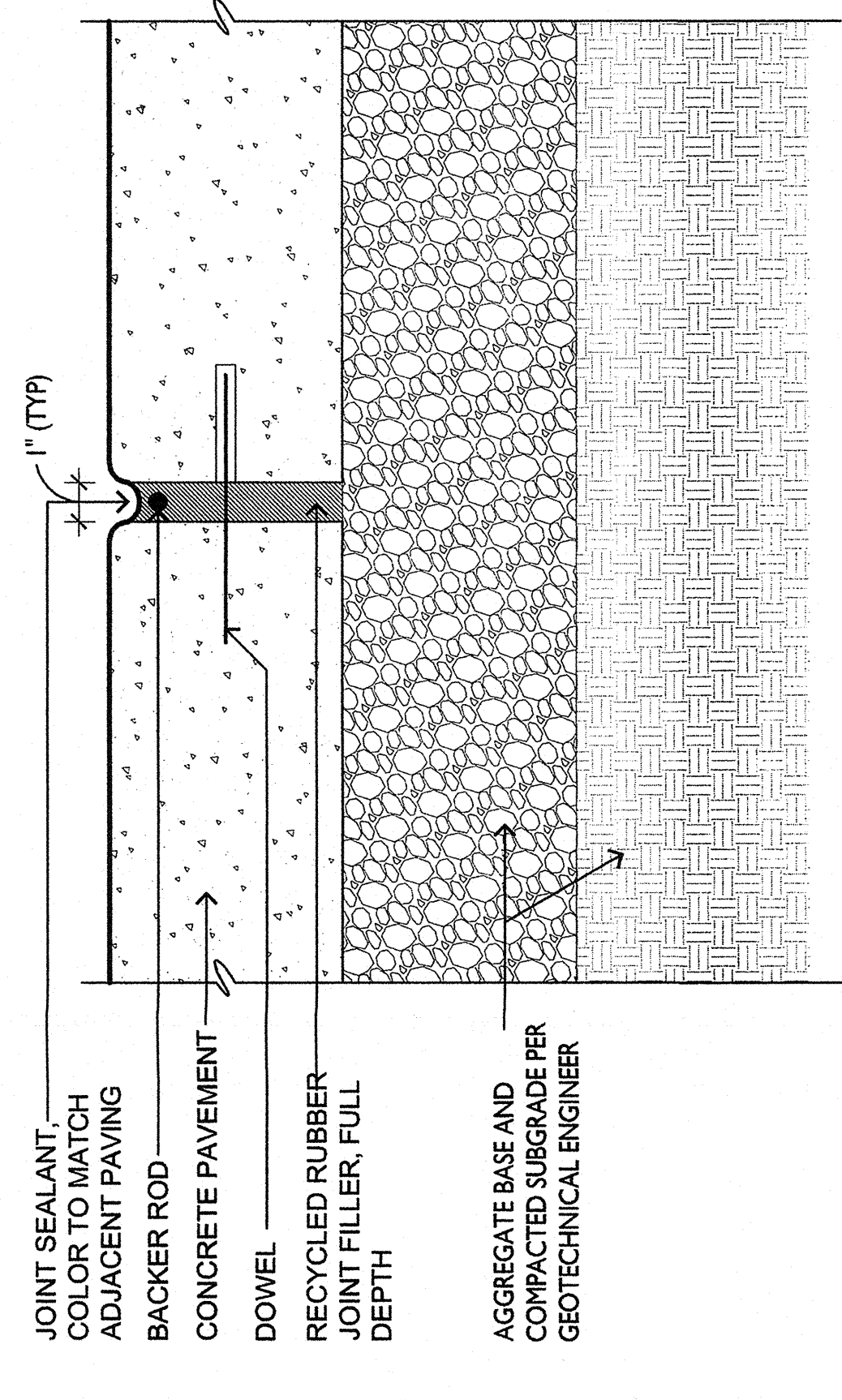

3 EXPANSION JOINT SCALE: 1" = 1'-0"

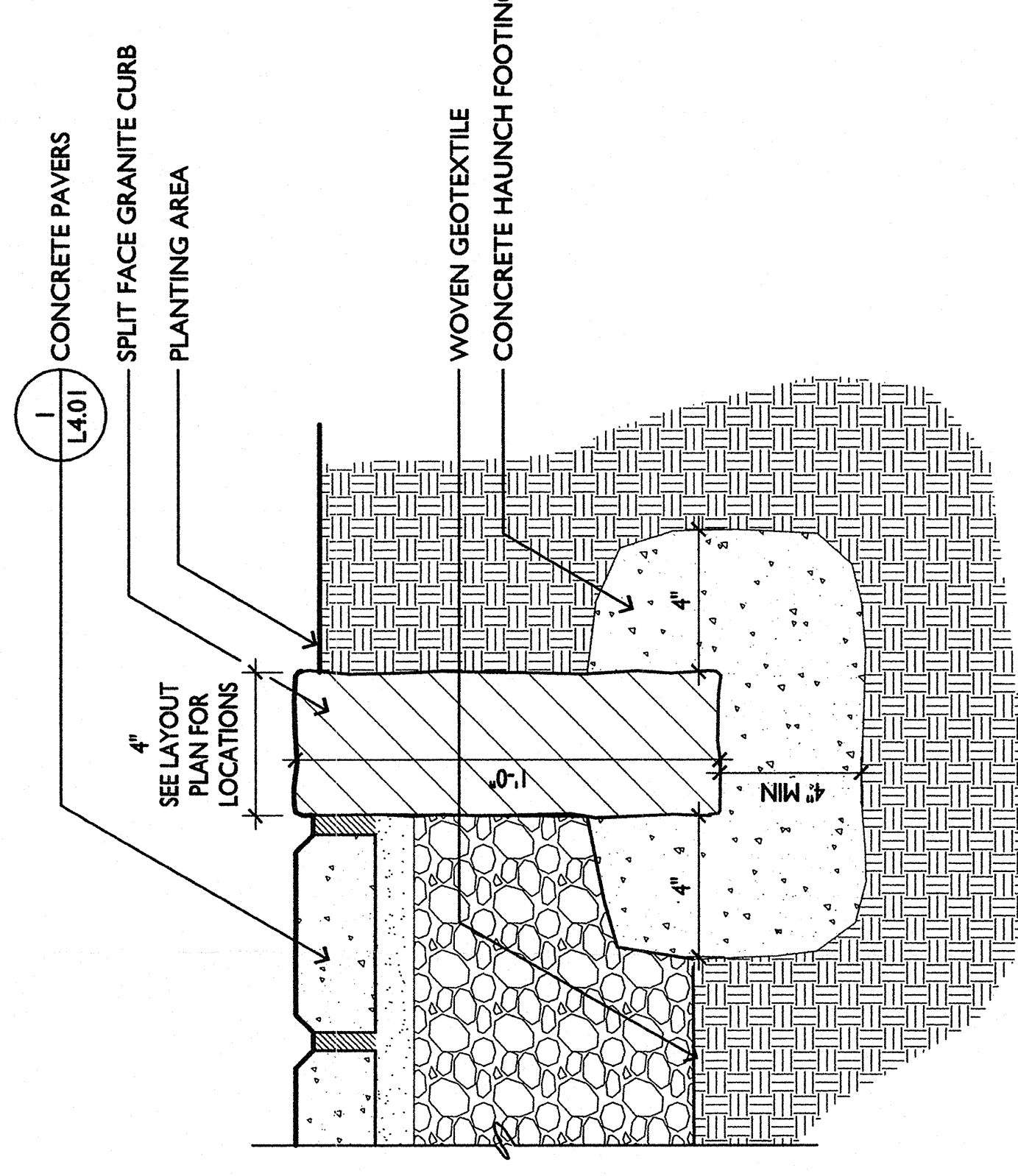

2 GRANITE CURB SCALE: 3/8" = 1'-0"

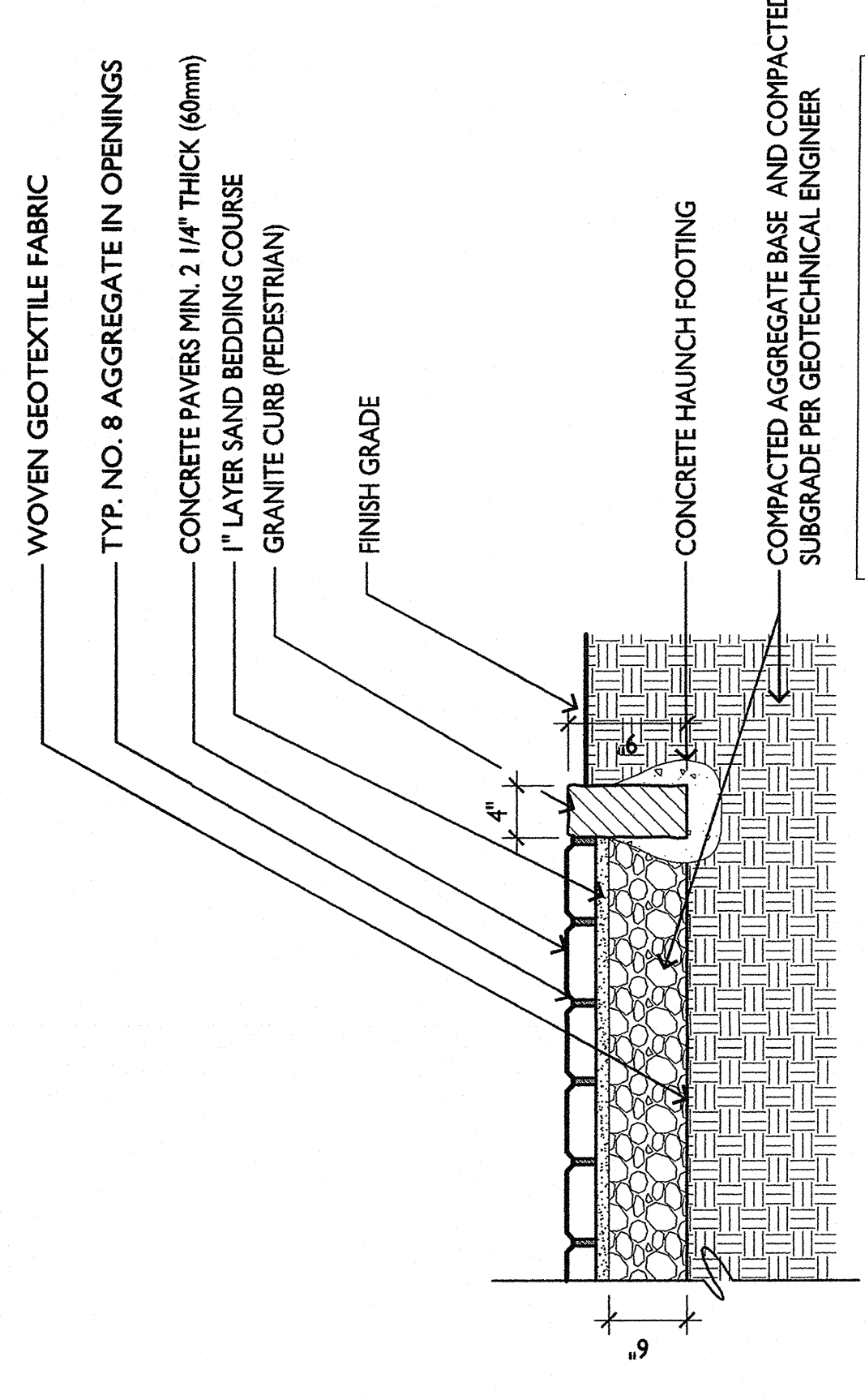

1 CONCRETE PAVERS SCALE: 1" = 1'-0"

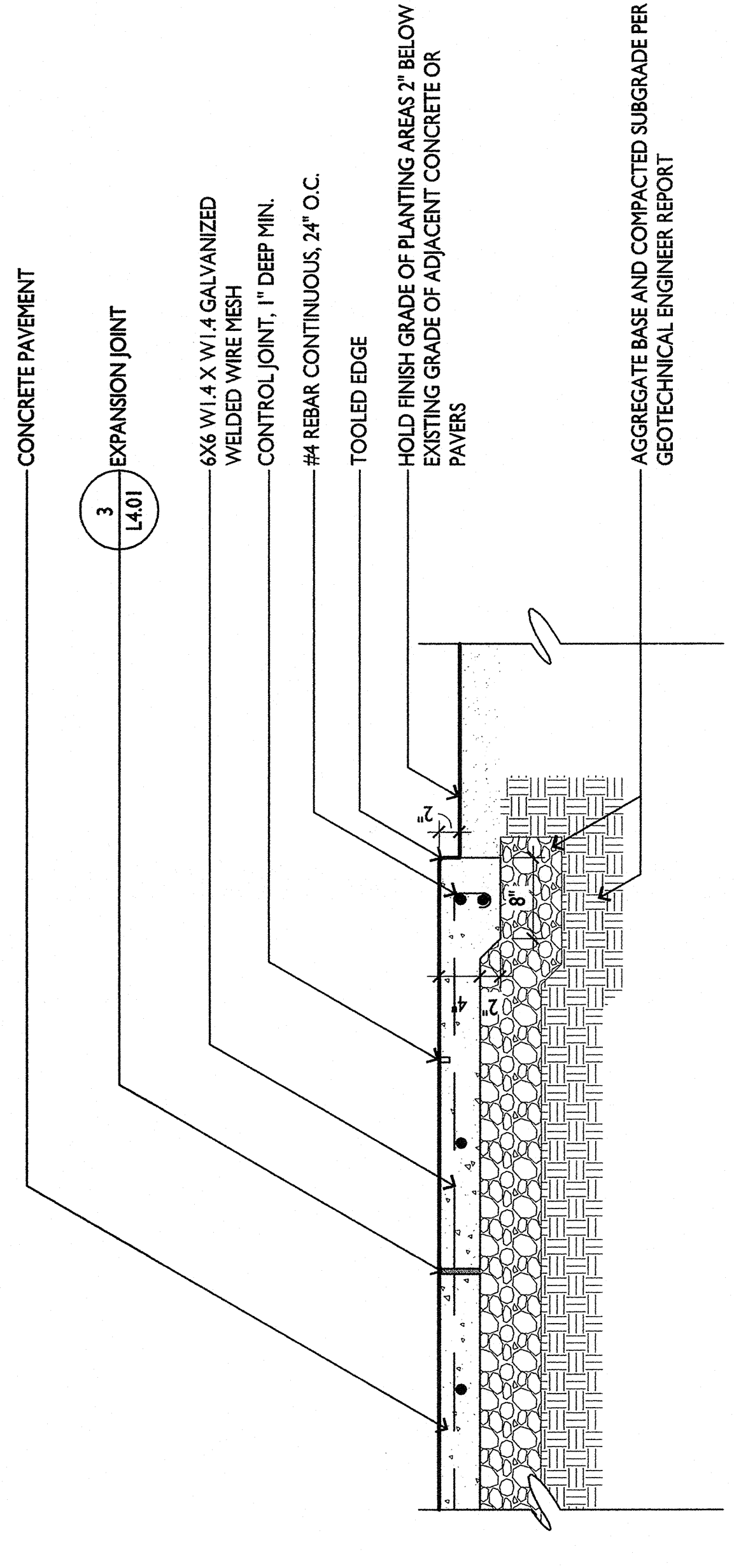

4 CONCRETE PAVEMENT SCALE: 1" = 1'-0"

Approved Const. Plan

Date: 10/4/17

Public Utilities

10/3/17

10/9/17

Signature: *[Signature]*

WILMINGTON
Public Services • Engineering Division
APPROVED DRAINAGE PLAN

Approved Const. Plan

Date: 10/4/17

Public Utilities

10/3/17

10/9/17

Signature: *[Signature]*

WILMINGTON
Public Services • Engineering Division
APPROVED DRAINAGE PLAN